

## Sealing Fittings

### EXPLOSIONPROOF

For UL.60079-1 Standard Class I,II Div.1 and 2 Groups B,C,D,E,F and G

For IEC.60079-0/1 Standard Zone 1 and Zone 2

#### Technical data

Type of Protection: Ex d IIA T6  
 Conforming to : Standards IEC 60079-1 or UL 60079-1  
 Marking for test : Ex II2G  
 Degree of Protection : IP67 acc.To IEC 60529  
 Ambient Temp. (Ta) : -20°C to+ 75 °C  
 Type :EY  
 Protection class for UL. : Class I, Division1 or 2 Group.B,C,D  
 Class II, Division 1 or 2 Groups.E,F,G  
 Class III  
 Protection class for IEC : Zone1and Zone 2  
 Conduit hub - 1/2" - 4" NPT.



ISO9001:2008



**EY**

#### Applications:

The Sealing fitting are used in conduit and cable system in hazardous areas to prevent the passage of gases, vapors or flames from one portion of the electrical installation to another through the conduit install with in 18 inches on any conduit run entering an enclosure which contains arcs, sparks or high temperature devices. install with in 18 inches from the enclosure or fitting housing terminals, splices or taps on each conduit run of 2 inches size or larger entering such enclosure of fitting. install in each conduit ren leaving the hazardous classified locations. seal where cable are required to use in Class I, Div. 2 locations.



**EYK**

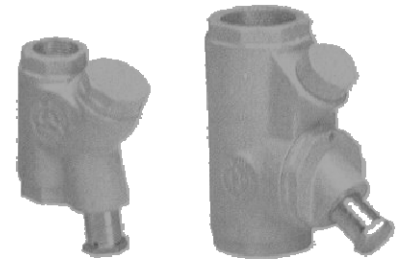

**EYD**



**EYL**

#### Features:

- Complete range of sizes for conduit or cable.
- Large opening provides easy compound filling.
- Female hub on top and bottom.
- Type **EYS** for sealing in vertical position.
- Type **EYK** for sealing in horizontal position.
- Type **EYD** for sealing in vertical position and provide continuous water drain path.
- Type **EYL** for sealing in angle conduit run.

#### Standard Materials:

- Body and cover - Copper-free aluminium
- Drain - Stainless steel

#### Standard Finishes:

- Copper-free aluminium - Epoxy-polyester powder
- Stainless steel - Natural



Male sealing fittings (Removable Male Nipple) add suffix - **M** to Cat., No.



Also suitable to use in

Class I, Div, 1 and 2 , Group B

for EY 1, EY 2, EY 3, EYK 1, EYK 2, EYK 3

**EXPLOSIONPROOF**

For UL.60079-1 Standard Class I,II Div.1 and 2 Groups **B,C,D,E,F** and G

For IEC.60079-0/1 Standard Zone 1 and Zone 2

**Catalogue Numbers and Dimensions:**

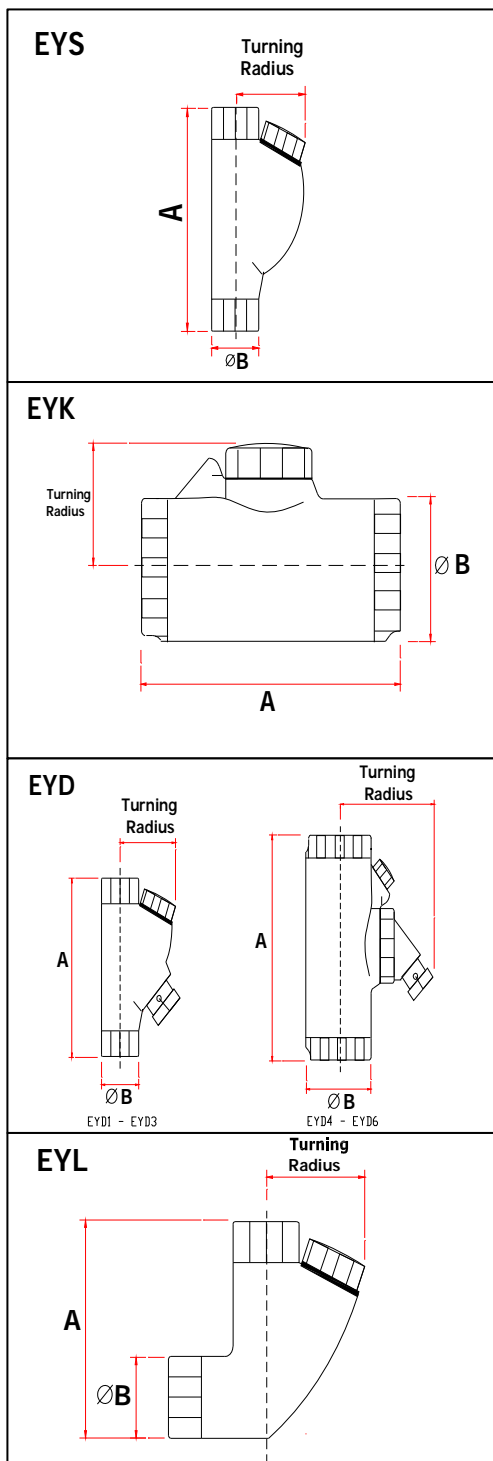

Conduit Size NPT. ( inch )	Cat., No.	Dimension in mm.		
		A	Ø B	Turning Radius #
1/2"	EY 1☆	76	31	49
3/4"	EY 2☆	86	39	57
1"	EY 3☆	97	43	68
1.1/4"	EY 4	124	54	82
1.1/2"	EY 5	136	62	97
2"	EY 6	162	76	119
2.1/2"	EY 7	217	107	155
3"	EY 8	217	107	155
3.1/2"	EY 9	253	128	193
4"	EY 10	253	136	189
1/2"	EYK 1☆	81	32	33
3/4"	EYK 2☆	93	38	36
1"	EYK 3☆	103	44	40
1.1/4"	EYK 4	121	60	55
1.1/2"	EYK 5	150	63	53
2"	EYK 6	176	76	68
2.1/2"	EYK 7	223	109	109
3"	EYK 8	223	109	109
3.1/2"	EYK 9	303	36	123
4"	EYK 10	303	36	123
1/2"	EYD 1	81	32	54✧
3/4"	EYD 2	93	38	57✧
1"	EYD 3	103	44	62✧
1.1/4"	EYD 4	121	60	88✧
1.1/2"	EYD 5	136	63	91✧
2"	EYD 6	150	76	101✧
1/2"	EYL 1	71	32	49
3/4"	EYL 2	93	38	56
1"	EYL 3	96	44	68
1.1/4"	EYL 4	110	59	85

**Remark:**

- ☆ See compliances on page 7
- # Turning radius with cover or plug removed.
- ✧ Turning radius with drain fitting removed.

**ERD , ERDS Reducers  
ETP Stopping plugs  
EED Enlargers**



**EXPLOSIONPROOF**

For UL.60079-1 Standard Class I,II Div.1 and 2 Groups C,D,E,F and G

For IEC.60079-1 Standard Zone 1 and Zone 2



ISO9001:2008

**● Applications:**

ERD and ERDS reducers are used in NPT conduit system to reduce the conduit hubs to a smaller size.  
ETP stopping plugs are provided for closing threaded conduit hubs of the explosionproof enclosure.  
EED enlargers are used in NPT conduit system to enlarge or adapt the conduit hubs in on step-up size.

**● Standard Materials:**

- ERD, ERDS - Aluminium or Bronze
- ETP - Copper-free aluminium
- EED - Aluminium or Bronze

**● Standard Finishes:**

- Aluminium - Natural
- Bronze - Natural or Chromium plated
- Copper-free aluminium - Epoxy-polyester powder coated.

**● Standard Size:**

- 1/2 to 4 inches NPT

**● Technical data ( for IEC standard )**

Type of protection	:	Ex d IIA T6 (for Zone 1&2)
Conforming to	:	IEC60079-1
Marking	:	Ex d II2G Ex d IIA T6
Degree of protection	:	IP 54 ( without gasket )
	:	IP 66 (with gasket)
	:	acc.to EN600529/IEC60529
Ambient temp.(ta)	:	- 20°C to +75°C

**● Options:**

Entry thread seal	:	Themoplastic elastomer or Rubber(NBR)
-------------------	---	--

**● Compliances: ( for UL standard )**

- UL standard 60079-1
- NEC Class I, Div. 1 and 2 , Groups C, D
- Class II, Div. 1 and 2 , Groups E,F,G
- Class III



ERD



ERDS



ETP



EED



A QUALITY PRODUCT

Catalogue Number :

## ERD , ERDS Reducers

### ETP Stopping plugs

### EED Enlargers

EXPLOSIONPROOF

For UL.60079-1 Standard Class I,II Div.1 and 2 Groups C,D,E,F and G

For IEC.60079-1 Standard Zone 1 and Zone 2

#### Reducers

NPT, Thread Size Male-Female ( inch )	Cat.,No.	
	ERD Type	ERDS Type
3/4" - 1/2"	ERD 21 <input type="checkbox"/>	ERDS 21 <input type="checkbox"/>
1" - 1/2"	ERD 31 <input type="checkbox"/>	ERDS 31 <input type="checkbox"/>
1" - 3/4"	ERD 32 <input type="checkbox"/>	ERDS 32 <input type="checkbox"/>
1.1/4" - 1/2"	ERD 41 <input type="checkbox"/>	ERDS 41 <input type="checkbox"/>
1.1/4" - 3/4"	ERD 42 <input type="checkbox"/>	ERDS 42 <input type="checkbox"/>
1.1/4" - 1"	ERD 43 <input type="checkbox"/>	ERDS 43 <input type="checkbox"/>
1.1/2" - 3/4"	ERD 52 <input type="checkbox"/>	ERDS 52 <input type="checkbox"/>
1.1/2" - 1"	ERD 53 <input type="checkbox"/>	ERDS 53 <input type="checkbox"/>
1.1/2" - 1.1/4"	ERD 54 <input type="checkbox"/>	ERDS 54 <input type="checkbox"/>
2" - 1"	ERD 63 <input type="checkbox"/>	ERDS 63 <input type="checkbox"/>
2" - 1.1/4"	ERD 64 <input type="checkbox"/>	ERDS 64 <input type="checkbox"/>
2" - 1.1/2"	ERD 65 <input type="checkbox"/>	ERDS 65 <input type="checkbox"/>
2.1/2" - 1.1/4"	ERD 74 <input type="checkbox"/>	ERDS 74 <input type="checkbox"/>
2.1/2" - 1.1/2"	ERD 75 <input type="checkbox"/>	ERDS 75 <input type="checkbox"/>
2.1/2" - 2"	ERD 76 <input type="checkbox"/>	ERDS 76 <input type="checkbox"/>
3" - 1.1/2"	ERD 85 <input type="checkbox"/>	ERDS 85 <input type="checkbox"/>
3" - 2"	ERD 86 <input type="checkbox"/>	ERDS 86 <input type="checkbox"/>
3" - 2.1/2"	ERD 87 <input type="checkbox"/>	ERDS 87 <input type="checkbox"/>
3.1/2" - 2"	ERD 96 <input type="checkbox"/>	ERDS 96 <input type="checkbox"/>
3.1/2" - 2.1/2"	ERD 97 <input type="checkbox"/>	ERDS 97 <input type="checkbox"/>
3.1/2" - 3"	ERD 98 <input type="checkbox"/>	ERDS 98 <input type="checkbox"/>
4" - 2.1/2"	ERD 107 <input type="checkbox"/>	ERDS 107 <input type="checkbox"/>
4" - 3"	ERD 108 <input type="checkbox"/>	ERDS 108 <input type="checkbox"/>
4" - 3.1/2"	ERD 109 <input type="checkbox"/>	ERDS 109 <input type="checkbox"/>

#### Enlargers

NPT, Thread Size Male-Female ( inch )	Cat.,No.
	1/2" - 3/4"
3/4" - 1"	EED 23 <input type="checkbox"/>
1" - 1.1/4"	EED 34 <input type="checkbox"/>
1.1/4" - 1.1/2"	EED 45 <input type="checkbox"/>
1.1/2" - 2"	EED 56 <input type="checkbox"/>
2" - 2.1/2"	EED 67 <input type="checkbox"/>
2.1/2" - 3"	EED 78 <input type="checkbox"/>
3" - 3.1/2"	EED 89 <input type="checkbox"/>
3.1/2" - 4"	EED 910 <input type="checkbox"/>

#### Stopping plugs

NPT, Thread Size (inch)	Cat.,No.
1/2"	ETP 1
3/4"	ETP 2
1"	ETP 3
1.1/4"	ETP 4
1.1/2"	ETP 5
2"	ETP 6
2.1/2"	ETP 7
3"	ETP 8
3.1/2"	ETP 9
4"	ETP 10

#### Options:

Specify material to Cat.,No.

A - Aluminium

B - Bronze

**EDF Drain Fitting****EXPLOSIONPROOF**

For UL.60079-1 Standard Class I,II Div.1 and 2 Groups C,D,E,F and G

For IEC.60079-1 Standard Zone 1 and Zone 2



ISO9001:2008

● **Applications:**

The EDF drain fitting is installed at bottom of enclosure or conduit system to drain water formed by condensation

● **Standard Materials:**

- Stainless steel

● **Standard Finishes:**

- Natural

● **Standard Size:**

- 1/2 inches NPT

● **Compliances: ( for UL standard )**

- UL standard 60079-1, IEC 60079-1
- NEC Class I, Div. 1 and 2 , Groups C, D  
Class II, Div. 1 and 2 , Groups E,F,G  
Class III



EDF

□

# ENP Nipple



## EXPLOSIONPROOF

For UL.60079-1 Standard Class I,II Div.1 and 2 Groups C,D,E,F and G

For IEC.60079-0/1 Standard Zone 1 and Zone 2



ISO9001:2008

### Technical data

- Type of Protection: Ex d IIA T6
- Conforming to : Standards IEC 60079-1 or UL 60079-1
- Marking for test : Ex II2G
- Degree of Protection : IP 66 acc.To IEC 60529
- Ambient Temp. (Ta) : -20°C to+ 75 °C
- Type : ENP
- Protection class for UL. : Class I, Division1 or 2 Group.C,D  
 Class II, Division1 or 2 Groups.E,F,G  
 Class III
- Protection class for IEC : Zone1 and Zone 2

### Specification:

- ENP - Brass - Natural or Chromium plated
- Standard Size - 1/2" - 2" NPT.

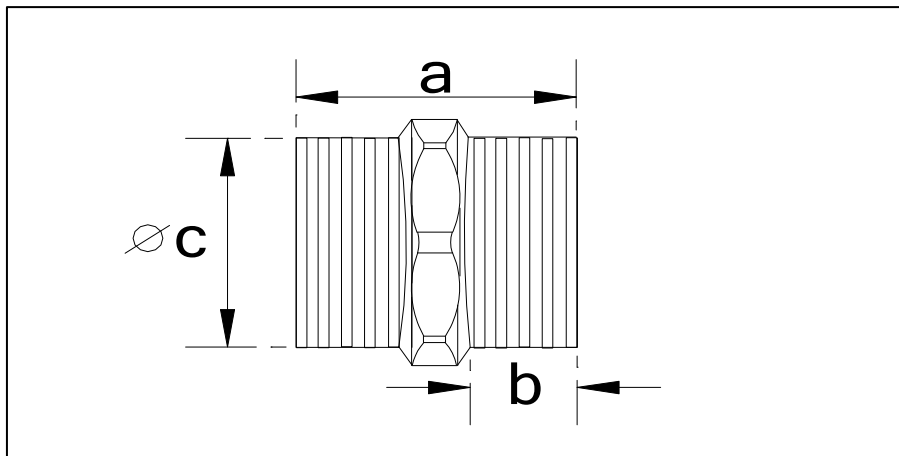

Conduit Size	Cat.,No.	Dimension in mm.		
		a	b	∅ c
1/2"	ENP1	34	13	12
3/4"	ENP2	38	14	17
1"	ENP3	54	19	24
1.1/4"	ENP4	55	21	28
1.1/2"	ENP5	55	22	33
2"	ENP6	80	30	45